

# Capital Markets Day 2023

## Increasing share of wallet to grow profits in tailored business

Olli Tevä

Senior Vice President, Sales and Marketing

## Disclaimer

This presentation contains forward-looking statements. These statements relate to future events of Exel Composites' future financial performance, including but not limited to strategic plans, potential growth, expected capital expenditures, future cash sources and requirements, liquidity and cost savings that involve known and unknown risks, uncertainties and other factors that may cause Exel Composites' actual results, levels of activity, performance or achievements to be materially different from those expressed or implied by any forward-looking statements. By their nature, forward-looking statements involve risks and uncertainties because they relate to events and depend on circumstances that may or may not occur in the future. Future results may vary from the results expressed in, or implied by, the following forward-looking statements, possibly to a material degree. Exel Composites assumes no obligation to update or revise any information included in this presentation. Nothing in this presentation constitutes investment advice, and this presentation does not constitute an offer to sell or the solicitation of an offer to buy any securities or otherwise to engage in any investment activity.

# Tailored business will have healthy growth

Historical and expected growth of the addressable market, BEUR

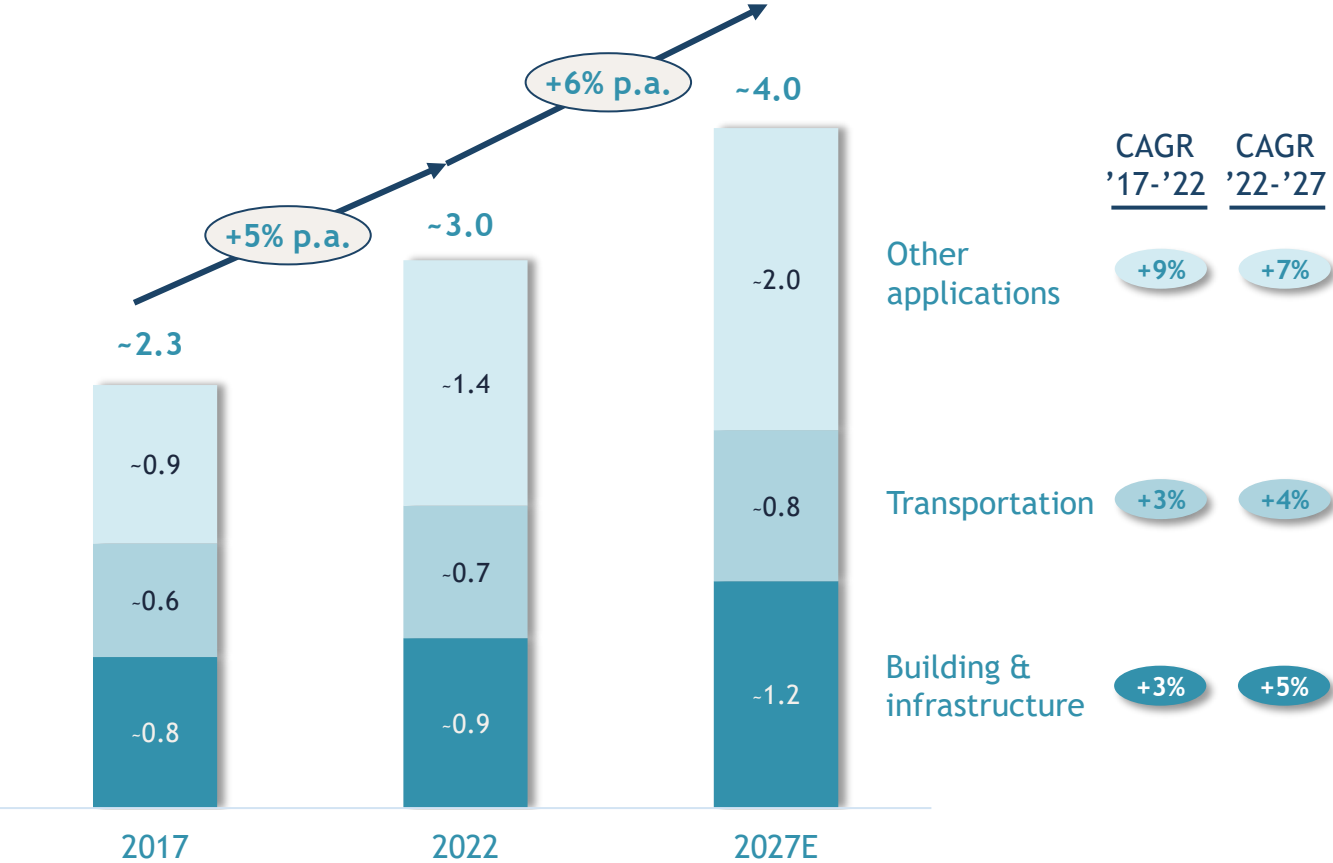

Source: IHS; The World Bank; Statista; Global Data; Global Wind Energy Council; U.S. Department of Energy, 3rd party market study

# Exel's stronghold, carbon fiber pultrusion: Growing number of high value add applications



## Tripods

Unique aesthetic and weight savings, stiffness for stability



## Drones

Thin-wall lightweight tubes to meet the high-strength and weight requirements



## Airships

High mechanical strength and stiffness with lightest weights & repeatable product consistency



## Arrows

Extreme thin-walls and stringent straightness and stiffness requirements

# Application engineering helping customer to apply composites

## Challenge

Customers are unfamiliar with composite material possibilities and restrictions & unable to specify optimal solution

# Application engineering helping customer to apply composites

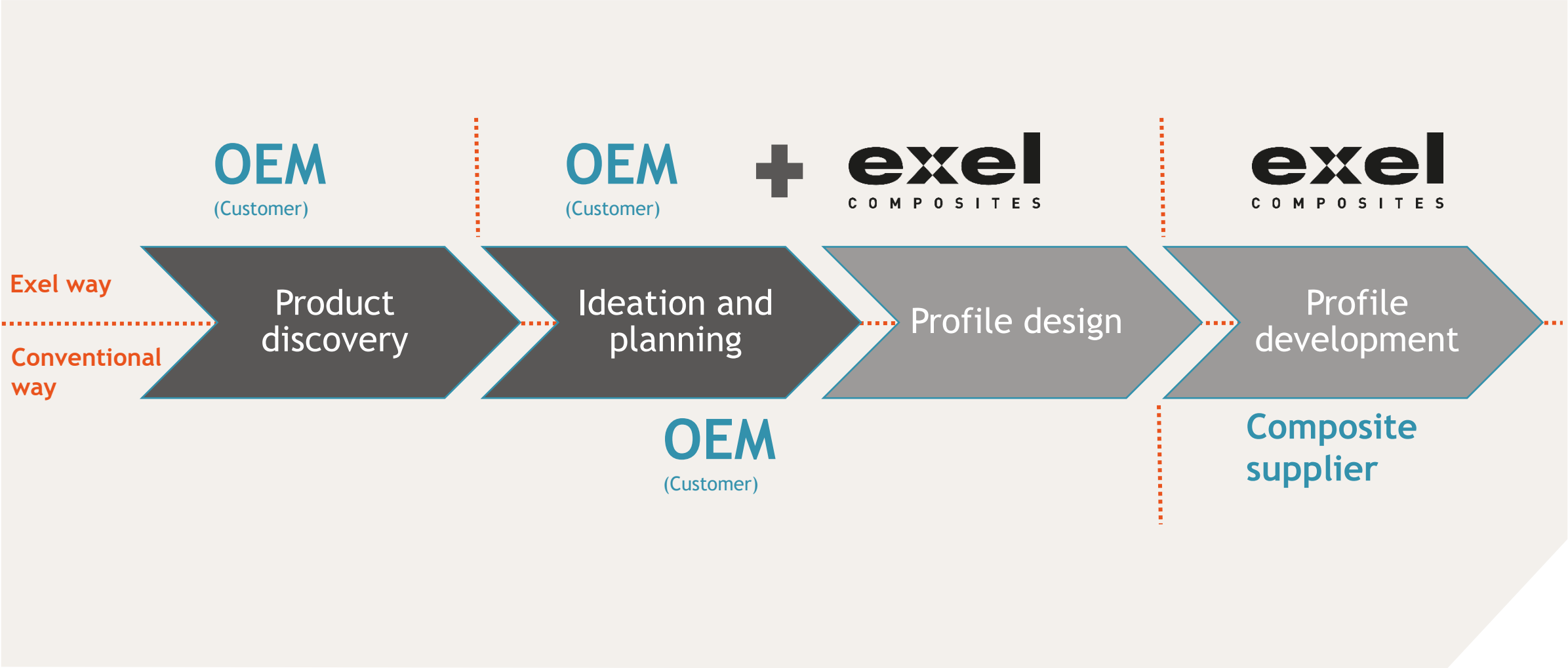

# Increase share of wallet by closing the gap in value stream

## Challenge

Customers are unfamiliar with composite material post processing

# Increase share of wallet by closing the gap in value stream

Conventional way

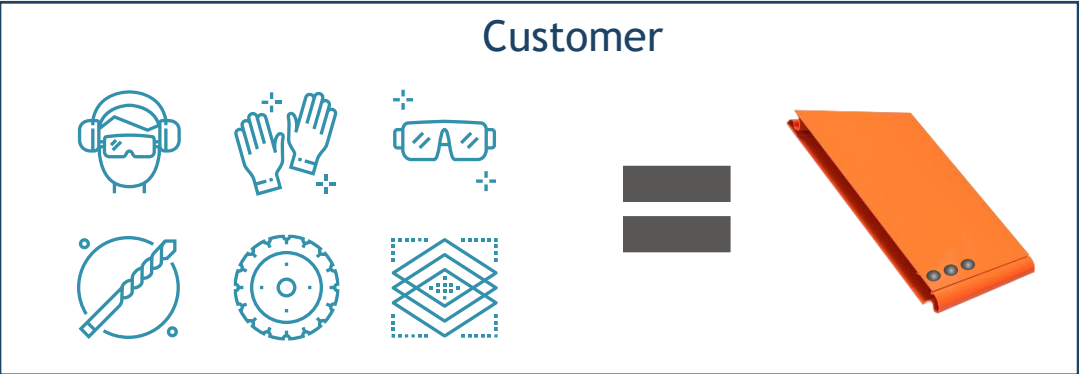
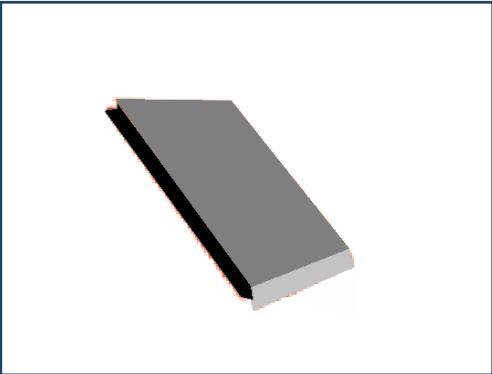



# Increase share of wallet by closing the gap in value stream

Conventional way

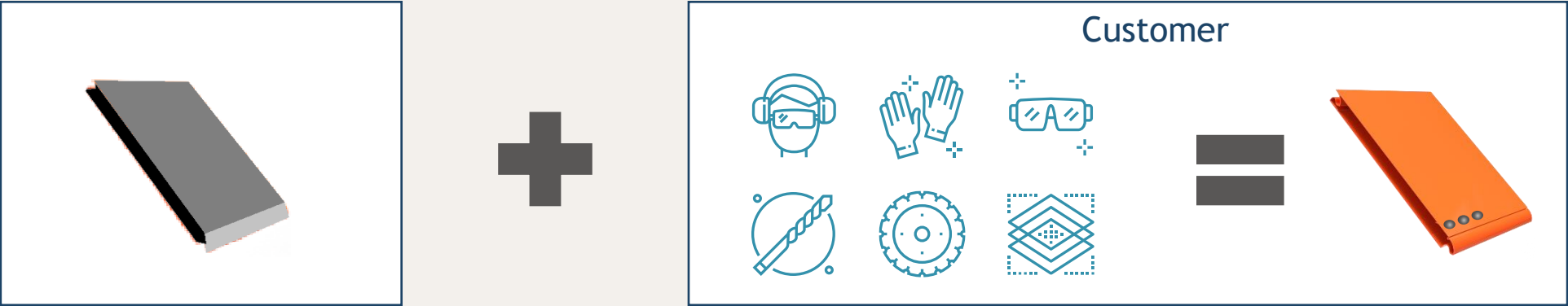

**exel**  
COMPOSITES  
Value-added approach

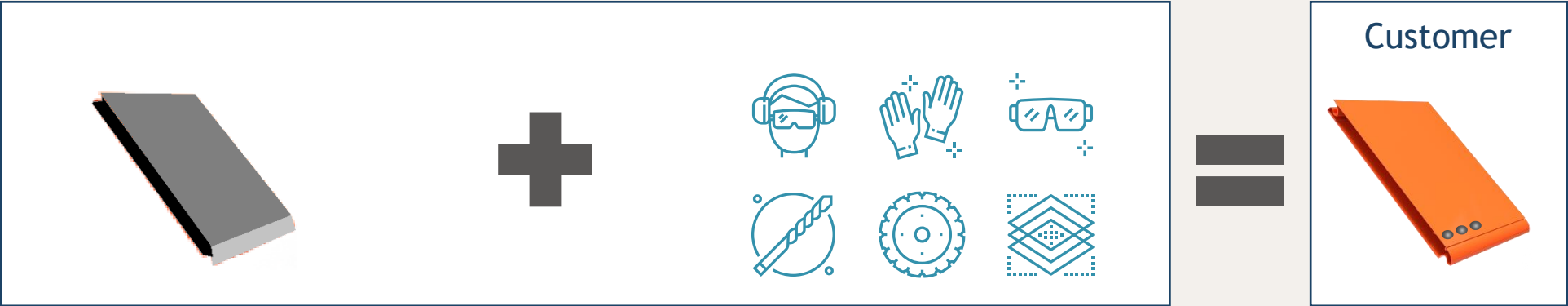

## Case: KONE UltraRope®



**Jeddah tower: 660 m  
elevator rise**



Photo source: KONE

**Closeup: UltraRope®  
elevator application**

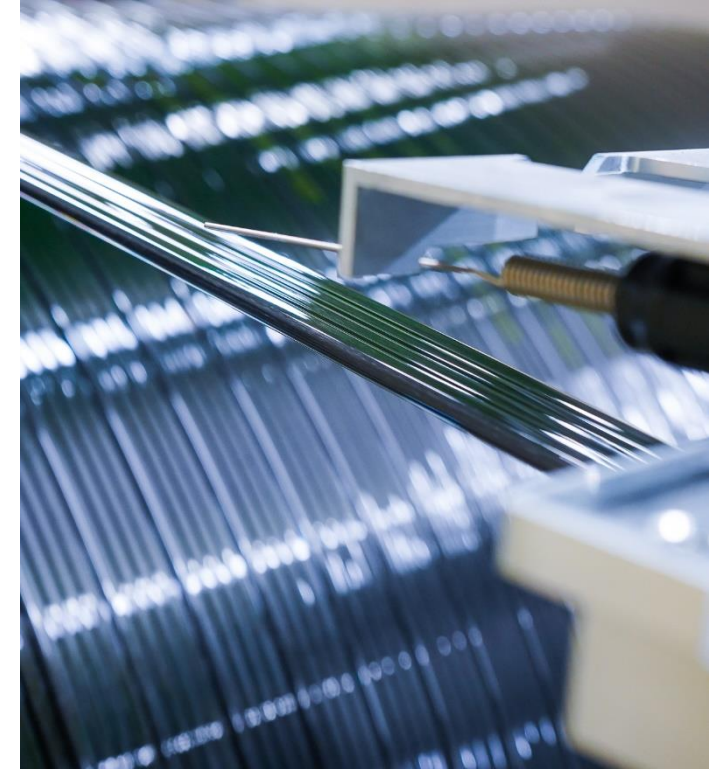

**Manufacturing at  
Exel Composites**

# Focused factories: shorter time to market and profitability

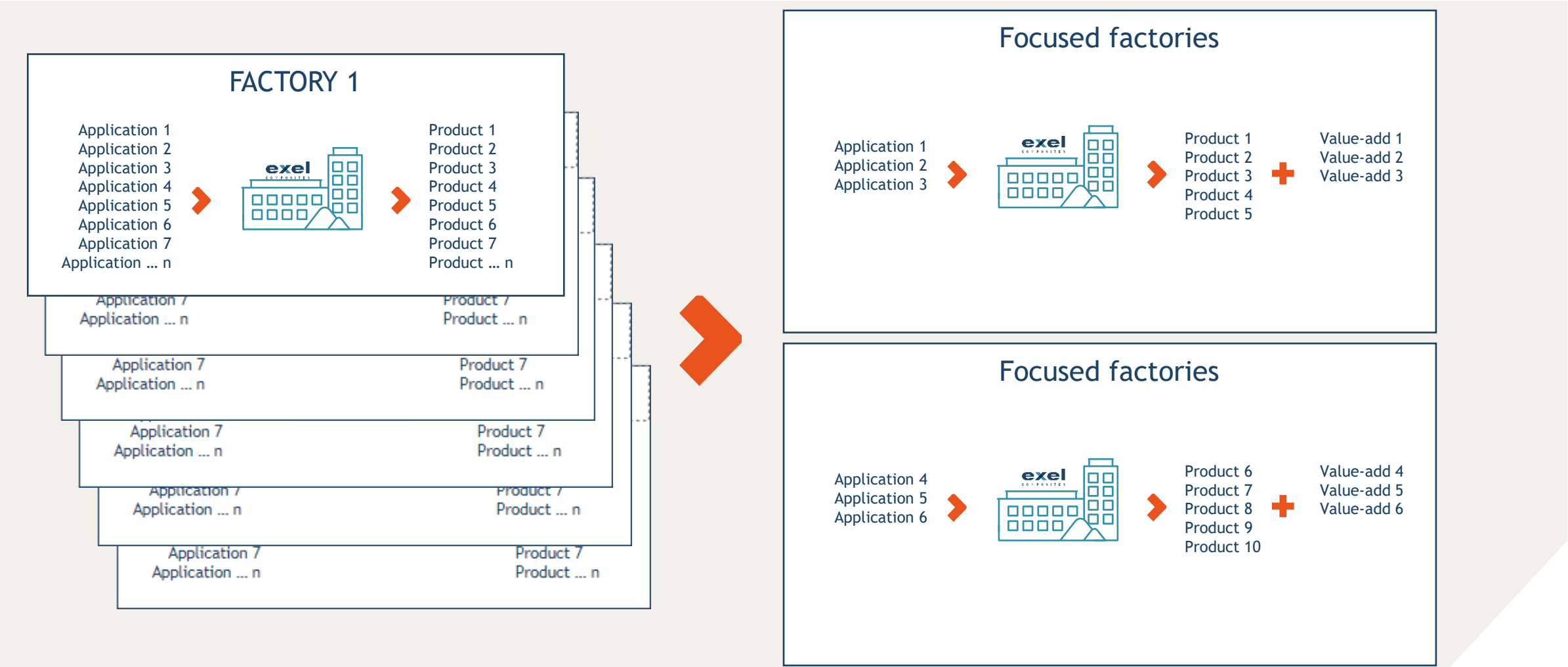

# Increasing share of wallet to grow profits in tailored business

Utilize strongholds

Engineering

Value adding services

Faster time to market

Bigger productions units



**exel** | FOR  
FORWARD  
THINKERS